



OASIS ULTRA FAST FLOW™



PRODUCT CATALOGUE 2014



Oasis Engineering Ltd
129 Birch Avenue, Tauranga 3110
New Zealand.
T: +64-7-928-3808
E: info@oasisngv.com
W: www.OasisNGV.com

Oasis Engineering USA Ltd
3701-A South Harvard Avenue #347
Tulsa, OK 74135-2282
Toll Free: 877-687-4430
E: usasales@oasisngv.com
W: www.OasisNGV.com



Cutting Edge

Mankind's first precision engineers sought perfection in their production. They chose the finest materials and developed innovative tools and practices to carve out exceptional results. Their workmanship can still inspire us today.

Carving the most powerful tool of his time from a single flint, a prehistoric engineer knew that the true worth of an arrow is its CUTTING EDGE.

At Oasis, this timeless focus on exceptional results through first class engineering is represented in the Arrowhead of our logo.

Providing CUTTING EDGE solutions for over a quarter of a century, Oasis Products are specified worldwide. We have the skill and capability to develop any part you require to the exact dimensions. Designed and manufactured in New Zealand, to your specifications, for the world.

We invite you to discover the best in precision engineering and manufacturing, provided by our good looking and friendly staff.

Oasis Engineering Ltd.

Oasis Engineering is a precision engineering production facility. [ISO 9001:2008 certified](#), the systems and processes are in place to ensure our CNC machine centres are crafting the most accurate, highest quality components that will meet your specifications.

Oasis Engineering specialises in the manufacture of high pressure fluid control devices for the Natural Gas Vehicle industry (NGV). Oasis [ball valves](#) were the first to deliver gas at 3600 PSI. This innovation and focus on quality remains today with the continued development of lowest life cost products.



ACCREDITED QUALITY



Oasis valves, couplings and swivels are internationally recognized as market leaders in high-pressure or sterile environments. The best machining tools, certified craftsmen, accredited quality manufacturing and people who value their trade, are what makes Oasis the quality component manufacturer of choice.

We only source the highest quality materials and can provide you with a certificate of product compliance and mill certificate. Our quality assurance systems and the equipment we use, also ensure you will receive the best design and LOWEST LIFE COST parts possible.

All our products are designed and crafted to provide durable, reliable service. We specialize in using high-end CNC machinery to make contaminant-free and polished surfaces.

Certified origin materials ensure all components are free of flaws, cracks or voids that could become bacterial traps.

All Oasis products can be customized to the dimensions you require, or check our website for a list of the standard sizes currently in production.

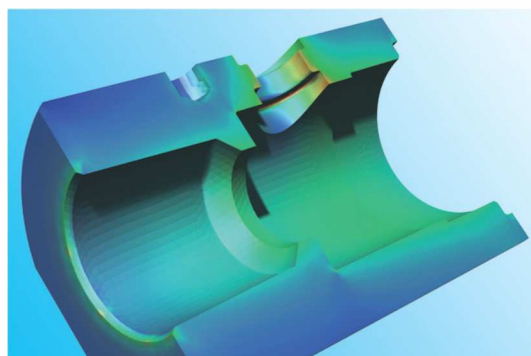

3/4" BALL VALVE WITH VENT VALVE



Features & Specifications

- Full Flow Design
- Integrated Vent Valve for Venting the Line Easily
- Anti-Blowout Stem Design
- Two Piece Valve
- Precision CNC Machined
- Easily Serviced
- Service Kits Readily Available
- NPT Female/Female Standard Thread Connections.
- Extended Cycle Testing to Ensure Longevity
- Delrin Seats
- Nitrile O-rings
- Manufactured from Certified 304 Stainless Steel Bar Stock. SS316 also Available
- Complies With PED 97/23/EC
- Part No. BV706-4E6ADDN-1000



3/4" BALL VALVE WITH VENT PORT



Features & Specifications

- Full Flow Design
- 1/4" Integrated Vent Port for Vent Valve, Pressure Gauge or Others
- Anti-Blowout Stem Design
- Two Piece Valve
- Precision CNC Machined
- Easily Serviced
- Service Kits Readily Available
- NPT Female/Female Standard Thread Connections.
- Extended Cycle Testing to Ensure Longevity
- Delrin Seats
- Nitrile O-rings
- Manufactured from Certified 304 Stainless Steel Bar Stock. SS316 also Available
- Complies With PED 97/23/EC
- Part No. BV706-4K6ADDN-1000



3/4" BALL VALVE WITH CODE 62



Features & Specifications

- Full Flow Design
- Code 62 Flanges on Both Ends
- Anti-Blowout Stem Design
- Two Piece Valve
- Precision CNC Machined
- Easily Serviced
- Service Kits Readily Available
- Extended Cycle Testing to Ensure Longevity
- Delrin Seats
- Nitrile O-rings
- Flanges as per SAE J518-2
- Manufactured from Certified 304 Stainless Steel Bar Stock. SS316 also Available
- Complies With PED 97/23/EC
- Part No. BV706-4Y6ADDN-M000



3/4" BALL VALVE WITH CODE 62 FLANGES TO SAE THREAD



Features & Specifications

- Full Flow Design
- Code 62 Flange to SAE End Connections
- Anti-Blowout Stem Design
- Two Piece Valve
- Precision CNC Machined
- Easily Serviced
- Service Kits Readily Available
- Extended Cycle Testing to Ensure Longevity
- Delrin Seats
- Nitrile O-rings
- Manufactured from Certified 304 Stainless Steel Bar Stock. SS316 also Available
- Flange as per SAE J518-2
- Complies With PED 97/23/EC
- Part No. BV706-4X6ADDN-M000



3/4" BALL VALVE WITH CODE 62 FLANGES TO NPT THREAD



Features & Specifications

- Full Flow Design
- Code 62 Flange to NPT End Connections
- Anti-Blowout Stem Design
- Two Piece Valve
- Precision CNC Machined
- Easily Serviced
- Service Kits Readily Available
- Extended Cycle Testing to Ensure
- Delrin Seats
- Nitrile O-rings
- Manufactured from Certified 304 Stainless Steel Bar Stock. SS316 also Available
- Flange as per SAE J518-2
- Complies With PED 97/23/EC
- Part No. BV706-4Z6ADDN-M000



3/4" BALL VALVE WITH CODE 62 FLANGES SERVICE KIT



Features & Specifications

- Complete Service Kit Available
- Easy to Install
- Pre-assembled Stem
- Ball & Stem Manufactured from Certified 316 Stainless Steel Bar Stock
- Precision CNC Machined
- Delrin Seats
- Nitrile O-rings
- Service Instructions Supplied and Available Online



BALL VALVES — 34 - 410 BAR (500 - 6000 PSI) — BV700 SERIES



Features & Specifications

- Full Flow Design
- Anti-Blowout Stem Design
- Two Piece Valve
- Precision CNC Machined
- Easily Serviced
- Service Kits Readily Available
- Extended Cycle Testing to Ensure Longevity
- NPT & SAE Female/Female Threads Available
- Sizes Available from 1/4" to 1"
- Delrin Seats (Peek Available)
- Nitrile O-rings (Viton Available)
- Manufactured from Certified 304 Stainless Steel Bar Stock. SS316 also Available
- ISO 15500 Compliant
- API STD 607 Approved
- Complies With PED 97/23/EC



BALL VALVE SERVICE KITS — 34 - 410 BAR (500 - 6000 PSI)



Features & Specifications

- Complete Service Kit Available
- Easy to Install
- Pre-assembled Stem
- Ball & Stem Manufactured from Certified 316 Stainless Steel Bar Stock
- Precision CNC Machined
- Delrin Seats
- Nitrile O-rings
- Service Instructions Supplied and Available Online



LOCK OUT HANDLE OPTION



Features & Specifications

- Fully Secure On/Off Locked Handle Position
- Stainless Steel Laser Cut Segment
- Padlock & Valve not included
- Easily Retrofitted onto Standard Valves
- Ideal for Isolation Functions



BALL VALVES — 0.48 - 410 BAR (7 - 6000 PSI) — BV700 SERIES



Features & Specifications

- Full Flow Design
- Anti-Blowout Stem Design
- Two Piece Valve
- Precision CNC Machined
- Easily Serviced
- Service Kits Readily Available
- Extended Cycle Testing to Ensure Longevity
- NPT & SAE Female/Female Threads Available
- Sizes Available from 1/2" to 1"
- Delrin Seats (Peek Available)
- Nitrile O-rings (Viton Available)
- Manufactured from Certified 304 Stainless Steel Bar Stock. SS316 also Available
- ISO 15500 Compliant
- API STD 607 Approved
- Complies With PED 97/23/EC



BALL VALVE SERVICE KITS — 0.48 - 410 BAR (7 - 6000 PSI)



Features & Specifications

- Complete Service Kit Available
- Easy to Install
- Pre-assembled Stem
- Ball & Stem Manufactured from Certified 316 Stainless Steel Bar Stock
- Precision CNC Machined
- Delrin Seats
- Nitrile O-rings
- Service Instructions Supplied and Available Online



REVERSING SEGMENT

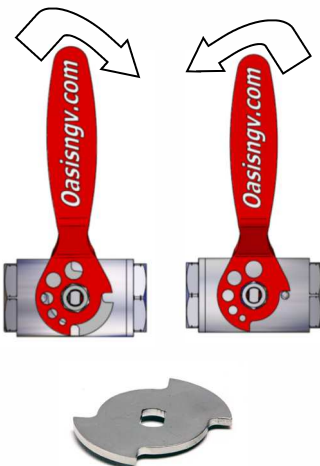

Features & Specifications

- Simple & Cost Effective Solution
- Changes Handle Operation Direction
- Laser Cut from Certified 304 Stainless Steel
- Robust & Simple Design
- Easy to Install



BALL VALVE WITH ACTUATOR MOUNTING KIT — BV700 SERIES



Features & Specifications

- Supplied Assembled Including Ball Valve, Bracket, Drive Dog and Bolts to Fit Actuator
- High Precision Stainless Steel Laser Cut Bracket
- Designed for Air Torque Actuators
- Extended Cycle Testing to Ensure Longevity
- Bolts Pattern to ISO 5211
- Ball Valve as per Valve Specifications
- Complies With PED 97/23/EC
- API STD 607 Approved
- ISO 15500 Compliant
- Sizes Available from 1/4" to 1"



BALL VALVE WITH AIRTORQUE ACTUATOR — BV700 SERIES



Features & Specifications

- Supplied Assembled Including Ball Valve, Drive Dog and Air Torque Actuator
- Spring Return Pneumatic Actuator
- High Precision Stainless Steel Laser Cut Bracket
- Extended Cycle Testing to Ensure Longevity
- Fail Close Standard Configuration
- Sizes Available from 1/4" to 1"



SOLID MODEL LIBRARY

Complete Solid Model Library of all our products for download available from our website at www.OasisNGV.com.
Contact us for Login details.



SANDWICH BALL VALVE — 34 TO 410 BAR — 7 TO 6000 PSI — SV100 SERIES



Features & Specifications

- Design for Manifold Applications
- Anti-Blowout Stem Design
- Minimize Service Down Time
- Two Piece Valve
- Easily Serviced
- Service Kits Readily Available
- Extended Cycle Testing to Ensure Longevity
- Precision CNC Machined
- Manufactured from Certified 304 Stainless Steel Bar Stock. SS316 also Available
- End Cap Connection Options Available Upon Request
- Delrin Seats (Peek Available)
- Nitrile O-rings (Viton Available)
- Sizes Available from 3/8" to 1"



SANDWICH BALL VALVE WITH ACTUATOR MOUNTING KIT — SV100 SERIES



Features & Specifications

- Design for Manifold Applications
- Anti-Blowout Stem Design
- Two Piece Valve
- Supplied Assembled Including Valve, Bracket, Drive Dog and Bolts to Fit Actuator
- High Precision Stainless Steel Laser Cut Bracket
- Easily Serviced
- Extended Cycle Testing to Ensure Longevity
- Precision CNC Machined
- Designed for Air Torque & Rotex Actuators
- End Cap Connection Options Available Upon Request
- Bolts Pattern to ISO 5211
- Sizes Available from 3/8" to 1"



SANDWICH BALL VALVE SERVICE KIT



Features & Specifications

- Complete Service Kit Available
- Easy to Install
- Pre-assembled Stem
- Ball & Stem Manufactured from Certified 316 Stainless Steel Bar Stock
- Precision CNC Machined
- Delrin Seats
- Nitrile O-rings
- Service Instructions Supplied and Available Online



SANDWICH BALL VALVE WITH AIRTORQUE ACTUATOR — SV100 SERIES



Features & Specifications

- Supplied Assembled Including Valve, Drive Dog and Air Torque Actuator
- Spring Return Pneumatic Actuator
- High Precision Stainless Steel Laser Cut Bracket
- Fail Close Standard Configuration
- Extended Cycle Testing to Ensure Longevity
- Sandwich Ball Valve as per Valve Specifications
- Sizes Available from 3/8" to 1"



SANDWICH BALL VALVE END CAPS OPTIONS

Features

Sandwich Ball Valve has been designed for manifold or valve applications where minimizing service down time is critical.

The flat face design allows to customized end caps connexions as per customer needs. These connexions can be made threaded (SAE, BSP, NPT), weld ends, tube lock, flanged, etc.



ONE PIECE CHECK VALVES — MAX PRESSURE: 410 BAR / 6000 PSI — CV100 SERIES



Features & Specifications

- Ideal for High Pressure Gas Applications
- High Duty Applications
- Simple Robust Design
- Precision CNC Machined
- Manufactured from Certified 303 Stainless Steel Bar Stock
- NPT Female/Female Thread Connections. Other Threads Available
- Size: 1/4"



CHECK VALVES — MAX PRESSURE: 410 BAR / 6000 PSI — CV200 SERIES



Features & Specifications

- High Flow Designed
- Easily Serviced
- Manufactured from Certified 304 Stainless Steel Bar Stock (SS316 also Available)
- Precision CNC Machined
- NPT Female/Female Thread Connections. Other Threads Available
- Service Kits Readily Available
- Sizes Available from 3/8" to 1 1/2"



ELECTRICAL ISOLATING COUPLER — MAX PRESSURE: 410 BAR / 6000 PSI — EC100 SERIES



Features & Specifications

- Full Flow Design
- Isolates a Section of Pipe to Allow the Safe Dissipation of Static Electricity Created by High Pressure Flow
- Reduces Pipe Corrosion
- Standard Product is NPT Male/NPT Female Connections. Other Threads also Available.
- Easily Serviced
- Service Kit Readily Available
- Precision CNC Machined
- Manufactured from Certified 304 Stainless Steel (SS316 Available)
- Sizes Available from 1/2" to 1"



CNG DISPENSER MANIFOLD

NEW

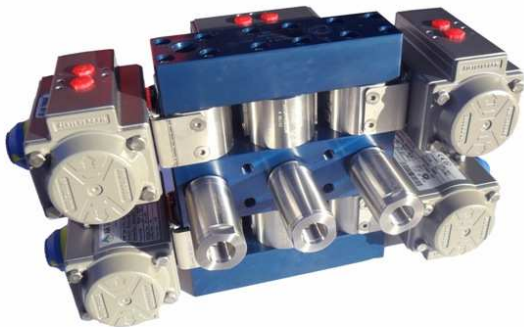

Features & Specifications

Oasis dispenser manifolds are designed with high flow rates in mind. Using Oasis sandwich valve and integrated check valve technology, we have created a compact high flow dispenser manifold that performs at the top of its game. When the time comes maintenance is easy with the extraction of the sandwich valve only requiring the removal of 4 bolts.

Part No.

DM104-84 — 1/2" SAE CNG Full Flow Dispenser Manifold



CNG PRIORITY MANIFOLD

NEW



Features & Specifications

Oasis has been creating custom solutions for some of the biggest names in the game. Providing the complete plug and play unit, Oasis can customize a manifold system that will integrate:

1. Sandwich Ball Valves
2. Check Valves
3. Coupling Systems

We have the capacity to design, prototype, test and manufacture a custom solution using either the manifold valve or the sandwich valve technology, delivering to you the complete package with total ease of service.

Part No.

- PM104-STD-SAE-ASM — 1/2" SAE CNG Priority Panel With Compressor Top Up

- PM104-TBL-SAE-ASM — 1/2" SAE CNG Priority Panel With Trailer Low Bank



45 DEGREE FILL VALVE WITH BUS & TRUCK NOZZLE — 240 - 248 BAR (3000 - 3600 PSI)

Features & Specifications



- 45 Degree Fill Valve Body Design with Bus & Truck Nozzle Assembled
- Hardened Segment Connection Nozzle Design Increases Gripping Surface Area & Reduces Wear in Receptors
- Port Adaptor Options Available Upon Request
- Extended Cycle Testing to Ensure Longevity
- Inlet Connection 3/4-16 SAE Female
- Fill Valve Designed to ANSI/CGA NGV1 Standard
- Nozzle Designed & Tested to ISO14469-2 Standard
- Nozzle to Fit DN12 (C200) Receptacles as per ISO 14469-2 Standard
- Complies with PED 97/23/EC
- Part No. FV103-4-020-C



90 DEGREE FILL VALVE WITH BUS & TRUCK NOZZLE — 240 - 248 BAR (3000 - 3600 PSI)

Features & Specifications



- 90 Degree Fill Valve Body Design with Bus & Truck Nozzle Assembled
- Hardened Segment Connection Nozzle Design Increases Gripping Surface Area & Reduces Wear in Receptors
- Port Adaptor Options Available Upon Request
- Extended Cycle Testing to Ensure Longevity
- Inlet Connection 3/4-16 SAE Female
- Fill Valve Designed to ANSI/CGA NGV1 Standard
- Nozzle Designed & Tested to ISO14469-2 Standard
- Nozzle to Fit DN12 (C200) Receptacles as per ISO 14469-2 Standard
- Complies with PED 97/23/EC
- Part No. FV103-9-020-C



180 DEGREE FILL VALVE WITH BUS & TRUCK NOZZLE — 240 - 248BAR (3000 - 3600PSI)

Features & Specifications



- 180 Degree Fill Valve Body Design with Bus & Truck Nozzle Assembled
- Hardened Segment Connection Nozzle Design Increases Gripping Surface Area & Reduces Wear in Receptors
- Port Adaptor Options Available Upon Request
- Extended Cycle Testing to Ensure Longevity
- Inlet Connection 3/4-16 SAE Female
- Fill Valve Designed to ANSI/CGA NGV1 Standard
- Nozzle Designed & Tested to ISO14469-2 Standard
- Nozzle to Fit DN12 (C200) Receptacles as per ISO 14469-2 Standard
- Complies with PED 97/23/EC
- Part No. FV103-0-AC6-C



45 DEGREE FILL VALVE WITH P30 (3000PSI) OR P36 (3600PSI) NGV1 NOZZLE



Features & Specifications

- 45 Degree Fill Valve Body Design with NGV1 P30/P36 Nozzle Assembled
- Hardened Segment Connection Nozzle Design Increases Gripping Surface Area & Reduces Wear in Receptors
- Port Adaptor Options Available Upon Request
- Extended Cycle Testing to Ensure Longevity
- Inlet Connection 3/4-16 SAE Female
- Designed to ANSI/CGA NGV1
- Complies with PED 97/23/EC
- Part Nos.
 - FV103-4-010-A (FV with P30 Nozzle)
 - FV103-4-010-B (FV with P36 Nozzle)



90 DEGREE FILL VALVE WITH P30 (3000PSI) OR P36 (3600PSI) NGV1 NOZZLE



Features & Specifications

- 45 Degree Fill Valve Body Design with NGV1 P30/P36 Nozzle Assembled
- Hardened Segment Connection Nozzle Design Increases Gripping Surface Area & Reduces Wear in Receptors
- Port Adaptor Options Available Upon Request
- Extended Cycle Testing to Ensure Longevity
- Inlet Connection 3/4-16 SAE Female
- Designed to ANSI/CGA NGV1
- Complies with PED 97/23/EC
- Part Nos.
 - FV103-9-010-A (FV with P30 Nozzle)
 - FV103-9-010-B (FV with P36 Nozzle)



180 DEGREE FILL VALVE WITH P30 (3000PSI) OR P36 (3600PSI) NGV1 NOZZLE



Features & Specifications

- 45 Degree Fill Valve Body Design with NGV1 P30/P36 Nozzle Assembled
- Hardened Segment Connection Nozzle Design Increases Gripping Surface Area & Reduces Wear in Receptors
- Port Adaptor Options Available Upon Request
- Extended Cycle Testing to Ensure Longevity
- Inlet Connection 3/4-16 SAE Female
- Designed to ANSI/CGA NGV1
- Complies with PED 97/23/EC
- Part Nos.
 - FV103-0-AD6-A (FV with P30 Nozzle)
 - FV103-0-AD6-B (FV with P36 Nozzle)



45 DEGREE FILL VALVE WITH BUS & TRUCK NOZZLE — 240 - 248 BAR (3000 - 3600 PSI)

Features & Specifications



- 45 Degree Fill Valve Body Design with Bus & Truck Nozzle Assembled
- Hardened Segment Connection Nozzle Design Increases Gripping Surface Area & Reduces Wear in Receptors
- Port Adaptor Options Available Upon Request
- Extended Cycle Testing to Ensure Longevity
- Inlet Connection 3/4-16 SAE Female
- Fill Valve Designed to ANSI/CGA NGV1 Standard
- Nozzle Designed & Tested to ISO14469-2 Standard
- Nozzle to Fit DN12 (C200) Receptacles as per ISO 14469-2 Standard
- Complies with PED 97/23/EC
- Part No. FV103-4-020-C



90 DEGREE FILL VALVE WITH BUS & TRUCK NOZZLE — 240 - 248 BAR (3000 - 3600 PSI)

Features & Specifications



- 90 Degree Fill Valve Body Design with Bus & Truck Nozzle Assembled
- Hardened Segment Connection Nozzle Design Increases Gripping Surface Area & Reduces Wear in Receptors
- Port Adaptor Options Available Upon Request
- Extended Cycle Testing to Ensure Longevity
- Inlet Connection 3/4-16 SAE Female
- Fill Valve Designed to ANSI/CGA NGV1 Standard
- Nozzle Designed & Tested to ISO14469-2 Standard
- Nozzle to Fit DN12 (C200) Receptacles as per ISO 14469-2 Standard
- Complies with PED 97/23/EC
- Part No. FV103-9-020-C



180 DEGREE FILL VALVE WITH BUS & TRUCK NOZZLE — 240 - 248BAR (3000 - 3600PSI)

Features & Specifications



- 180 Degree Fill Valve Body Design with Bus & Truck Nozzle Assembled
- Hardened Segment Connection Nozzle Design Increases Gripping Surface Area & Reduces Wear in Receptors
- Port Adaptor Options Available Upon Request
- Extended Cycle Testing to Ensure Longevity
- Inlet Connection 3/4-16 SAE Female
- Fill Valve Designed to ANSI/CGA NGV1 Standard
- Nozzle Designed & Tested to ISO14469-2 Standard
- Nozzle to Fit DN12 (C200) Receptacles as per ISO 14469-2 Standard
- Complies with PED 97/23/EC
- Part No. FV103-0-AC6-C



45 DEGREE FILL VALVE WITH P30 (3000PSI) OR P36 (3600PSI) NGV1 NOZZLE



Features & Specifications

- 45 Degree Fill Valve Body Design with NGV1 P30/P36 Nozzle Assembled
- Hardened Segment Connection Nozzle Design Increases Gripping Surface Area & Reduces Wear in Receptors
- Port Adaptor Options Available Upon Request
- Extended Cycle Testing to Ensure Longevity
- Inlet Connection 3/4-16 SAE Female
- Designed to ANSI/CGA NGV1
- Complies with PED 97/23/EC
- Part Nos.
 - FV103-4-010-A (FV with P30 Nozzle)
 - FV103-4-010-B (FV with P36 Nozzle)



90 DEGREE FILL VALVE WITH P30 (3000PSI) OR P36 (3600PSI) NGV1 NOZZLE



Features & Specifications

- 45 Degree Fill Valve Body Design with NGV1 P30/P36 Nozzle Assembled
- Hardened Segment Connection Nozzle Design Increases Gripping Surface Area & Reduces Wear in Receptors
- Port Adaptor Options Available Upon Request
- Extended Cycle Testing to Ensure Longevity
- Inlet Connection 3/4-16 SAE Female
- Designed to ANSI/CGA NGV1
- Complies with PED 97/23/EC
- Part Nos.
 - FV103-9-010-A (FV with P30 Nozzle)
 - FV103-9-010-B (FV with P36 Nozzle)



180 DEGREE FILL VALVE WITH P30 (3000PSI) OR P36 (3600PSI) NGV1 NOZZLE



Features & Specifications

- 45 Degree Fill Valve Body Design with NGV1 P30/P36 Nozzle Assembled
- Hardened Segment Connection Nozzle Design Increases Gripping Surface Area & Reduces Wear in Receptors
- Port Adaptor Options Available Upon Request
- Extended Cycle Testing to Ensure Longevity
- Inlet Connection 3/4-16 SAE Female
- Designed to ANSI/CGA NGV1
- Complies with PED 97/23/EC
- Part Nos.
 - FV103-0-AD6-A (FV with P30 Nozzle)
 - FV103-0-AD6-B (FV with P36 Nozzle)



FILL VALVE WITH 50mm NGV1 NOZZLE EXTENSION



Features & Specifications

- 45 & 90 Degree Fill Valve Body Design with 50mm NGV1 P30/P36 Nozzle Extension Assembled
- Hardened Segment Connection Nozzle Design Increases Gripping Surface Area & Reduces Wear in Receptors
- Port Adaptor Options Available Upon Request
- Extended Cycle Testing to Ensure Longevity
- Inlet Connection 3/4-16 SAE Female
- Designed to ANSI/CGA NGV1
- Complies with PED 97/23/EC
- Part Nos.
 - FV103-4-0E0-A (FV with P30 Nozzle)
 - FV103-9-0E0-B (FV with P36 Nozzle)



FILL VALVE WITH 100mm NGV1 NOZZLE EXTENSION



Features & Specifications

- 45 & 90 Degree Fill Valve Body Design with 100 mm NGV1 P30/P36 Nozzle Extension Assembled
- Hardened Segment Connection Nozzle Design Increases Gripping Surface Area & Reduces Wear in Receptors
- Port Adaptor Options Available Upon Request
- Extended Cycle Testing to Ensure Longevity
- Inlet Connection 3/4-16 SAE Female
- Designed to ANSI/CGA NGV1
- Complies with PED 97/23/EC
- Part Nos.
 - FV103-4-0F0-A (FV with P30 Nozzle)
 - FV103-9-0F0-B (FV with P36 Nozzle)



FILL VALVE EXTENSIONS AND ADAPTORS



Features & Specifications

- Precision CNC Machined
- Manufactured from Certified Stainless Steel Bar Stock

Adaptors required to fit NGV1 Nozzle or Bus & Truck Nozzle to Fill Valve



45 DEGREE FILL VALVE — 410 BAR (6000 PSI) — FV100 SERIES



Features & Specifications

- Full Flow
- 45 Degree Body Design
- Manufactured from Certified Aluminium & 304 Stainless Steel Bar Stock
- Serviceable
- Ports adaptors available on requests
- Extended Cycle Testing to Ensure Longevity
- Precision CNC Machined
- Inlet & Outlet Connections 3/4-16 SAE Female
- Complies with PED 97/23/EC
- Designed to ANSI/CGA NGV1 Standard
- Part No. - FV103-4-000-0

Adaptor required to fit to NGV1 Nozzle or Bus & Truck Nozzle



90 DEGREE FILL VALVE — 410 BAR (6000 PSI) — FV100 SERIES



Features & Specifications

- Full Flow
- 90 Degree Body Design
- Manufactured from Certified Aluminium & 304 Stainless Steel Bar Stock
- Serviceable
- Ports adaptors available on requests
- Extended Cycle Testing to Ensure Longevity
- Precision CNC Machined
- Inlet & Outlet Connections 3/4-16 SAE Female
- Complies with PED 97/23/EC
- Designed to ANSI/CGA NGV1 Standard
- Part No. - FV103-9-000-0

Adaptor required to fit to NGV1 Nozzle or Bus & Truck Nozzle



180 DEGREE FILL VALVE — 410 BAR (6000 PSI) — FV100 SERIES



Features & Specifications

- Full Flow
- 180 Degree Body Design
- Manufactured from Certified Aluminium & 304 Stainless Steel Bar Stock
- Serviceable
- Ports adaptors available on requests
- Extended Cycle Testing to Ensure Longevity
- Precision CNC Machined
- Inlet & Outlet Connections 3/4-16 SAE Female
- Complies with PED 97/23/EC
- Designed to ANSI/CGA NGV1 Standard
- Part No. - FV103-0-AA6-0

Adaptor required to fit to NGV1 Nozzle or Bus & Truck Nozzle



FILL VALVE SERVICE KIT



Features & Specifications

- Complete Service Kit Available
- Easy to Install
- Price Competitive
- Readily Available
- Pre-Assembled Stems
- Balls & Stems Manufactured from Certified 316 Stainless Steel Bar Stock
- Precision CNC Machined
- Delrin Seats
- Nitrile O-rings
- Service Instructions Supplied and Available Online
- Part No. FV103-SKDN



FILL VALVE HANDLE SERVICE KIT



Features & Specifications

- Complete Service Kit Available
- Easy to Install
- Precision CNC Machined & Laser Cut
- Part No. FV103-70



FILL VALVE TWO-PIECE HANDLE SLEEVE



Features & Specifications

- Complete Service Kit Available
- Easy to Install
- Black Nylon Material
- Part No. FV103-17



BUS & TRUCK NOZZLE — 200 - 248BAR (3000 - 3600PSI) — NC100 SERIES



Features & Specifications

- Serviceable
- Manufactured from Certified 316 Stainless Steel Bar Stock
- Extended Cycle Testing to Ensure Longevity Hardened Segment Connection Design Increases Gripping Surface Area & Reduces Wear in Receptors
- Inlet Adaptor Connections Available
- Nozzle to Fit DN12 (C200) Receptacles as per ISO 14469-2 Standard
- Nozzle Designed & Tested to ISO 14469-2 Standard
- Complies with PED 97/23/AC
- Class A tested to 100,000 + cycles
- Part No. NC104-200

Adaptor required to fit to Fill Valve



NGV1 NOZZLES — 200 BAR (3000 PSI) & 248 BAR (3600 PSI) — NC100 SERIES



Features & Specifications

- Serviceable
- Manufactured from Certified 316 Stainless Steel Bar Stock
- Extended Cycle Testing to Ensure Longevity
- Hardened Segment Connection Design Increases Gripping Surface Area & Reduces Wear in Receptors
- Inlet Adaptor Connections Available
- Designed to ANSI/CGA NGV1 Standards
- Complies with PED 97/23/AC
- Class A tested to 100,000 + cycles
- Part Nos.
 - NC103-P30 (Blue)
 - NC103-P36 (Yellow)

Adaptor required to fit to Fill Valve



BUS & TRUCK NOZZLE / NGV1 NOZZLES SERVICE KITS



Features & Specifications

- Complete Service Kit Available.
- Easy to Install
- Price Competitive
- Readily Available
- Pre-Assembled Poppet
- Precision CNC Machined
- Service Instructions Supplied and Available Online
- Part Nos.
 - NC104-SK200 (For Bus & Truck Nozzle)
 - NC103-SKNGV1 (For NGV1 Nozzle)



BREAKAWAY COUPLER — 410BAR (6000PSI) — BC100 SERIES



Features & Specifications

- High Flow Design
- 1/2" NPT Female to 1/2" NPT Female Connections
- Hardened Segments Connection Design Increases Gripping Surface Area
- Easily Serviced
- Service Kit Readily Available
- Spring Loaded Poppet in Both Sides
- Service Kit Available
- Precision CNC Machined
- Manufactured from Certified 304 Stainless Steel Bar Stock
- Supplied with Assembly Tool
- Designed to ANSI-NGV 4.4
- Part Nos.
 - BC104-4NTBN (Breakaway)
 - BC104-4NTBN-2 (Breakaway with Vent)



BREAKAWAY ADAPTERS



Features & Specifications

- To Fit 3/4" and 1" Hoses
- Stainless Steel 316 Material
- Part Nos.
 - ADT-04/06 MF NT (1/2" NPT Male to 3/4" NPT Female)
 - ADT-04/08 MF NT (1/2" NPT Male to 1" NPT Female)

BREAKAWAY SERVICE KIT



Features & Specifications

- Complete Service Kit Available
- Easy to Install
- Price Competitive
- Readily Available
- Pre-Assembled Poppet
- Male & Female Parts Service Kit Available
- Precision CNC Machined
- Service Instructions Supplied and Available Online
- Part Nos.
 - BC104-SKTBN (Breakaway Service Kit)
 - BC101-SK (Vent Line Service Kit)

Oasis Tool required to install service kit, see Page 24



TANK HEAD VALVE



Features & Specifications

- Full Flow—Anti-Blowout Stem Design
- Minimizes Cylinder Neck Valves Constriction
- Positional Adjustable Adapter/Valve Combination
- Suitable for Most Bulk Industrial Gases
- Quarter Turn Handle
- Manufactured from Certified Stainless Steel Bar Stock
- Service Kit Readily Available
- Other PRD and End Caps Options Available
- Certified to ANSI/AGA NGV 3.1
- Certified to ISO 15500-4
- Part Nos.
 - TH104-42B1200-1000 (1/2" Tank Head Valve)
 - TH104-SK1 (1/2" Tank Head Valve Service Kit)

Other options available upon request. Contact Oasis for further details.



TRAILER LOAD/UNLOAD MANIFOLD



Features & Specifications

- Compact Full Flow Manifold System
- Anti-Blowout Stem Design
- Double Quick Release Coupler Ports
- Integrated 1/4" Ball Valve
- Suitable for Most Bulk Industrial Gases
- Quarter Turn Handles
- Saves installation time and cost
- Service Kit Readily Available
- Saves Commissioning Time — Reduces Joint Inspections
- Manufactured from Certified Stainless Steel Bar Stock
- Part Nos.
 - TM106-4N62DDN-E000 (Manifold)
 - TM106-SK62DDN (Service Kit)



HIGH PRESSURE QUICK RELEASE COUPLER — 310BAR (4500PSI) — HC200 SERIES



Features & Specifications

- High Flow Design
- Available in 3/4" & 1" Sizes
- Manufactured from Certified 316 Stainless Steel Bar Stock
- Serviceable
- Designed to ISO7241-1 Series B Profile
- Tested to ISO7241-2
- Standard Connection NPT Threads
- Extended Cycle Testing to Ensure Longevity
- Hardened Segment Connection Design Increases Gripping Surface Area & Reduces Wear in Receptors
- Part Nos.
 - HC206-6NCSN-F (3/4" NPT — Female Part)
 - HC206-6NCSN-M (3/4" NPT — Male Part)
 - HC208-6NDCN-F (1" NPT — Female Part)
 - HC208-6NDCN-M (1" NPT — Male Part)



HP QUICK RELEASE COUPLER — MAX PRESSURE: 410 BAR (6000 PSI) — HC100 SERIES



Features & Specifications

- High Flow Design
- NPT Female/Female Thread Connections. Other Threads Available
- Hardened Segment Connection Design Increases Gripping Surface Area
- Easily Serviced
- Service Kits Readily Available
- Precision CNC Machined
- Manufactured from Certified 316 Stainless Steel Bar Stock
- Part Nos.
 - HC104-6NTSN-F (1/2" NPT Female Part)
 - HC104-6NTSN-M (1/2" NPT Male Part)



HIGH PRESSURE QUICK RELEASE COUPLER SERVICE KIT



Features & Specifications

- Complete Service Kit Available
- Easy to Install
- Price Competitive
- Readily Available
- Pre-Assembled Poppet
- Male & Female Parts Service Kit Available
- Precision CNC Machined
- Service Instructions Supplied and Available Online

Oasis Tool required to install service kit, See Page 24



HIGH PRESSURE QUICK RELEASE COUPLER DUST CAPS

NEW



Features & Specifications

- Protects Quick Coupler Male Part from Dust, Water and hits
- Durable material
- Part Nos.
 - SHC208-17 (Compatible with HC208-6NCSN-M)

QUICK COUPLERS & BREAKAWAY SERVICING TOOLS

NEW



Features & Specifications

- Useful to Remove Poppet Retainer When Servicing
- Part Nos.
 - TOOL-HC104— For Breakaway & 1/2" HP Quick Release Coupler HC104
 - TOOL-HC206— For 3/4" HP Quick Release Coupler HC206
 - TOOL-HC208— For 1" HP Quick Release Coupler HC208

www.OasisNGV.com

Visit our Website To Find Out More About Us:

- Oasis Engineering Team
- What We Do
- Product Data Sheets
- Servicing Instructions
- Installation Instructions
- Solid Model Library
- Videos
- Case Studies
- Blogs

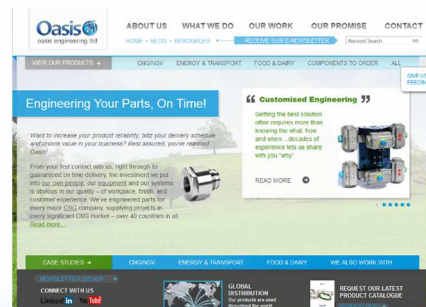

e2e — Engineer to Engineer

e2e



At Oasis Engineering we are passionate about SETTING THE STANDARD when it comes to our products & processes. As well as our standard range of products we can also customise or manufacture to your requirements. All our sales team are engineers so please talk to us e2e (Engineer 2 Engineer) to discuss your very own requirements.

Here are examples of some of the things that we have been commissioned to undertake.

CUSTOM VALVE EXTENSION

Specification Details



Testament to the “freakishly good” design of the Oasis Ball valve, the Oasis valve is being retrofitted to many installations. Maintaining the proven long cycle life of the Oasis Ball valve, the custom valve extension is used when a non-Oasis valve being replaced is longer in length than the Oasis standard design.

We can custom manufacture a cap that will meet the length dimensions for your needs. Talk to us e2e so that we can craft a solution that meets your needs.

ACCESSORIES

CUSTOMIZED HANDLE SOLUTIONS



Features & Specifications

- Customized Handle Solutions to Suit Your Requirements
- Laser cut from Stainless Steel
- Powder Coated
- Printed Logo Design



BALL VALVE ASSEMBLY TOOL



Features & Specifications

- Ball Valve Assembly Tool
- Quick Release Coupler Poppet Assembly Tool
- Fill Valve Holders



Oasis Ultra Fast

Truck

Tank Head Valve
TH100 Series

Fuel Manifold

Fill valve With
Bus & Truck Nozzle
FV103 Series

Dispenser

Breakaway
BC100 Series

Dispenser Manifold
DM100 Series

Priority Panel
PM100 Series

Tank
TH100 Series

From Compresor

Sandwich Valves
SV100 Series

Ball Valves
BV700 Series

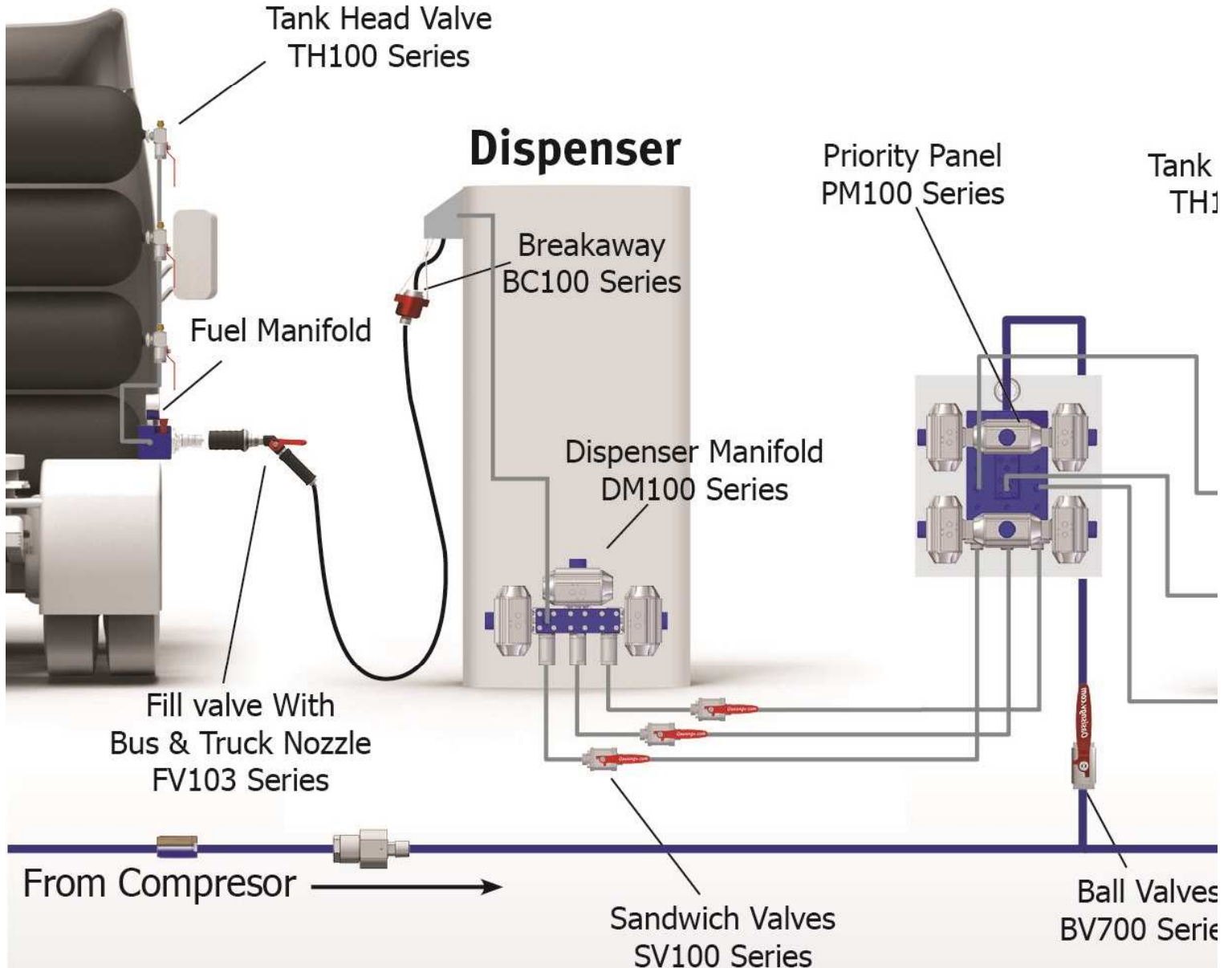

st Fill System™

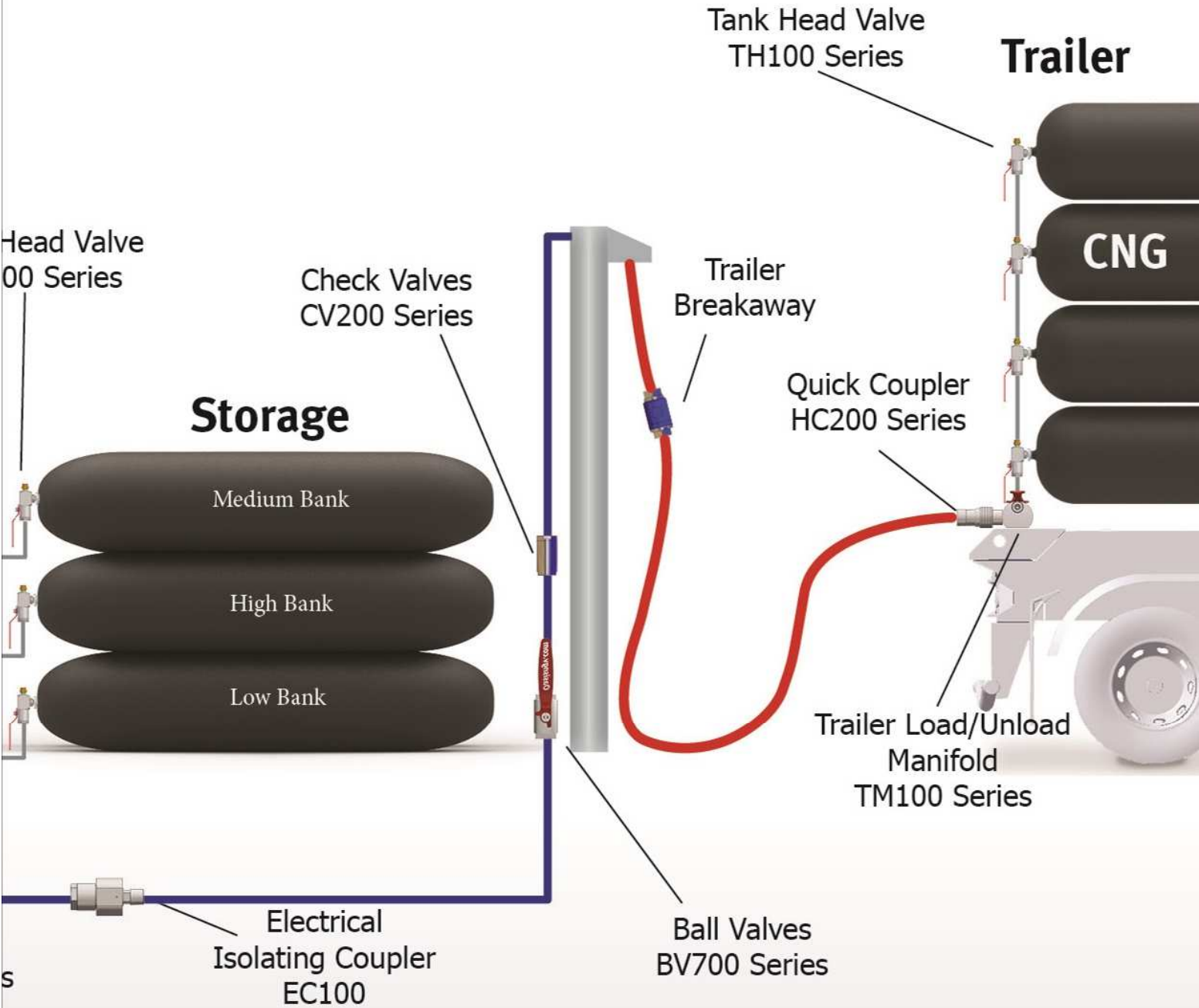

Contact us



Canada

Tecvalco

3481 Stanley Ave., Niagara Falls, Ontario L2E 6S4
Ph. Toll Free: 866 317 0131
e-mail: rgava@tecvalco.com
Web: www.tecvalco.com

China

Beijing Sameee Cryogenics Co., Ltd.

#9048 Ruian Bldg., 102 Dongsanhuan South Rd., Chaoyang district, Beijing, China 100021
Ph. +86-10-8732-4766
e-mail: jpyan3e@sameee.com
Web: www.sameee.com

Colombia

Globalmech Ingeniería

Calle 129 # 53a-31 Bogota, Colombia
Ph. +57 1 609 5787
e-mail: menriqueangel@yahoo.com

Indonesia

PT Jentera Dinamika Andal

TB Angke 34L Jakarta Barat, Indonesia
Ph. +62 21 564 8188
e-mail: Jda@centrin.net.id
Web: www.jda.co.id

Israel

Leer Engineering & Trading Ltd.

22 Hamelacha St. Bldg 4A, Rosh Haayin, Israel 4809162
Ph. +972 3 5379555
www.leereng.com
e-mail: dhart@leereng.com

Korea

Sameee Corporation Limited

401 Jungwoo-town #2 1228-1 Shingil-Dong Ansan, Kyunggi-Do 425-839 South Korea
Ph. +82 31 492 1691
e-mail: dmc3e@hanmail.net
Web: www.sameee.net

Malaysia

Suvinco Trading

37, Jalan D, Taman Batu off Jalan Kuching 52000 Kuala Lumpur Malaysia.
Ph. +60 1 26523648
e-mail: suvinco_trading@yahoo.com
Web: www.suvinco.com

New Zealand

Oasis Engineering Limited

129 Birch Avenue, Tauranga, 3110
Ph. +64 7 928 3808
e-mail: info@oasisngv.com
Web: www.OasisNGV.com

Peru

Sitecflu SAC

Jr. Conococha # 479 Urb. Covida, Los Olivos – Lima 39
Ph. +51 1 5228875
e-mail: ventas@sitecflu.com
Web: www.sitecflu.com

Sweden & Europe

Items

Box 2088, 44402 Stora Höga
Ph. +46 303 798130
e-mail: info@items.se
Web: www.items.se

Mexico

Acerall

Blvd. Diaz Ordaz 130, Colonia Santa Maria, SUITE 1082, Monterrey, N.L.
CP: 64650
Ph. +52 81 8851 8223
e-mail: contacto@acerall.net
Web: www.acerall.net

Thailand

Ananda Innovation Co. Ltd. (AIC)

2036/6 Rimthandrod fai-saipaknam Rd., Phrakanong, Klongtoey, Bangkok, 10260, Thailand
Ph. +66 2 741 5529
e-mail: sales@ananda-innovation.com
Web: www.ananda-innovation.com

Turkey

SmartGaz Enerji Limited Şti.

Yenişehir district Osmanlı boulevard Atlantis Shopping Center B Blok No:19, Pendik-Istanbul, Turkey.
Ph. +90 216 685 1011
e-mail: info@smartgaz.com.tr
Web: www.smartgaz.com.tr

United States of America

Oasis Engineering USA Limited

3701-A South Harvard Avenue #347, Tulsa, Oklahoma
Toll Free: 877 687 4430
Ph. 678 972 1621
e-mail: usasales@oasisngv.com
Web: www.OasisNGV.com

Tulsa Gas Technologies

4809 S.101st East Ave. Tulsa, OK USA 74146
Ph. 918 665 2641
e-mail: tbailey@tulsagastech.com
Web: www.tulsagastech.com

Venezuela

Matco Technology CA

RIF J-30499953-4 Av. Sur Centro Empresarial Lagunita Piso 4 # 416 Uur. La Lagunita Country Club Caracas 1081 Venezuela
Ph. +58 212 961 0673
e-mail: matcot@cantv.net
Web: www.matcotechnology.com